



TRAVEL WITH FRIENDS IN 2016



Mystical Myanmar

A LUXURY CRUISE ON THE UPPER AYEYARWADY

with Judy Tenzing | 06 – 21 December 2016 (18 days)





TOUR LEADER

Judy Tenzing has a lifelong passion for India and the Himalaya and with over 30 years' experience as an administrator and tour leader on the great sub-continent she has a great deal to share with her fellow travellers. Judy has a degree in South Asian History and regularly presents courses at Sydney University's Centre for Continuing Education on Indian and Himalayan history and culture. In 2001 Judy published the definitive book on the history of Sherpa mountaineering – *Tenzing and the Sherpas of Everest*.

Images on the cover: Mandalay cityscape with Royal Palace; The Anawrahta; Monks on early morning food offering and the temples of Bagan.

This page (right): Sagaing hill



Mystical Myanmar

A LUXURY CRUISE ON THE UPPER AYEYARWADY

Take a journey back in time through 'mystical Myanmar' on this luxury cruise along the majestic Upper Ayeyarwady River, combined with the splendours of Bagan and the colonial charm of Yangon.

Whilst this journey features stays in Bagan and Yangon, the highlight will definitely be the 12-day cruise along the much less frequently explored Upper Ayeyarwady as far north as Bhamo. Scenic highlights include long stretches of unspoilt river, thick forests, tall mountains and the passages through the Irrawaddy 'defiles'.

For this journey we have secured exclusive use of the Anawrahta (max 46 passengers), the latest addition to the acclaimed Heritage Line fleet of luxury 'classic ships' that evoke the 'golden age of travel'.

At a glance...

- Includes return flights on Thai Airways via Bangkok
- Relax and enjoy a 12 day cruise on the luxury Anawrahta with a choice of Deluxe Staterooms, Junior Suites, Executive Suites and Royal Suites
- Discover colonial-era towns and unspoilt villages seemingly 'lost in time'
- Marvel at the wonders of Bagan, the ancient capital of the Kingdom of Pagan
- Finish in Yangon, a mix of colonial architecture, modern high-rises and gilded Buddhist pagodas



To book, call **1300 727 095 (AU)** or **0800 403 621 (NZ)**, visit **renaissancetours.com.au** or contact your travel agent.



Young budhhist monks

Tue 06 December 2016 Australia – Yangon

Morning departure from Australia on Thai Airways flights via Bangkok to Yangon arriving in the evening. After immigration, luggage collection and customs transfer to the hotel.

This evening join your tour leader and fellow travellers for a welcome reception with light refreshments. **(R)**

Wed 07 Dec Yangon – Mandalay

Check-out from the hotel and transfer to the airport for a mid-morning flight to Mandalay. On arrival enjoy lunch in a local restaurant followed by a visit to the Shwenandaw Monastery, famous for its intricate wood-carvings.

Continue to the Mandalay Palace, the royal palace of the last Burmese monarchy constructed between 1857 and 1859 as part of King Mindon's founding of the new royal capital city of Mandalay. **(B L)**

Embarkation

Thu 08 Dec Mandalay – Mingun – Kyaungmyaung

After a morning at leisure transfer to the Anawrahta for embarkation. Enjoy lunch on board while the ship casts off. In the early afternoon visit Mingun, the site of the uncompleted Pahtodawgyi pagoda, a monumental uncompleted stupa began by King Bodawpaya in 1790. The completed stupa would have been the largest in the world at 150 meters and has the largest ringing bell weighing 90 tons.

Enjoy a welcome aboard dinner with a performance of Burmese traditional costumes. **(B L D)**

Fri 09 Dec Kyaungmyaung – Tagaung

After passage of the Third Defile, arrive at Kyaungmyaung, which is famous for its manufacture of large glazed earthenware pots known as Martaban jars. The biggest of these jars can hold about 105 gallons (over 400 litres). Late in the afternoon sail past the beautiful island pagoda of Thihadaw toward Tagaung. **(B L D)**

Sat 10 Dec Tagaung – Katha

In the morning, visit the ancient city of Tagaung. This town plays a key role in Myanmar folklore, with chronicles mentioning it as the first capital of Myanmar and therefore the place in which all subsequent kingdoms are rooted. One of the main sights in town is the shrine of a powerful nat (spirit) named Tagaung Bo Bo Gyi and is considered by worshippers to be the most powerful spirit in Myanmar. **(B L D)**

Sun 11 Dec Katha – Shwegu

In the morning, take a trishaw to explore the enchanting colonial town of Katha. Katha is the site of George Orwell's famous book *Burmese Days*, a story of what life was like in a remote station during the colonial era. The town is still charming with its teak homes and quaint streets.

In the afternoon, take a small boat to visit Shwegu, a long ribbon of township that stretches for three miles along the river bank. The village lies at the end of the

spectacular second Shwegu and features large family potteries making unglazed earthenware pots employing a technique of throwing and beating. **(B L D)**

Mon 12 Dec Shwegu – Bhamo – Shwe Paw

Today, cruise from Shwegu toward Bhamo, where the river cuts its way with narrow channels through a beautiful gorge with high cliffs and thick forests. This is known as the Second Defile and is the most northerly navigable point on the Irrawaddy. The town is the closest and most accessible point on the river to China (the border is 65km away) and one end of the famous old caravan trail up the Daying Jiang valley which Marco Polo followed in the 13th century, a route still in use today. Explore the local market often filled with ethnic tribes such as Kachin, Lisu and Shan. This evening cruise down river and anchor at Shwe Paw. **(B L D)**

Tue 13 Dec Shwe Paw – Katha

In the morning, visit the picturesque island of Shwe Paw and its ancient pagodas. Then continue cruising to visit the riverside village of Mae Dar before cruising downstream toward Katha. **(B L D)**

Wed 14 Dec Katha – Kyanhnydat

In the morning, take a train to the forest station of Naba and journey into the thick Kachin jungle and teak forests. Back on board and enjoy cruising with a nice river view. **(B L D)**

Thu 15 Dec Kyanhnydat – Mandalay

In the morning, cruise to Thabeitkyin and take a tour to Mogok. Mogok has been famous since ancient times for its gemstones, especially ruby and sapphire, but semi-precious stones such as lapis lazuli, garnet, moonstone, peridot and chrysoberyl are also found. The gems are found in alluvial limestone gravels by means of panning, tunnelling and digging pits by hand. You will be driven further into a Burmese teak forest to meet working elephants. In the afternoon the ship will sail downstream toward Mandalay. **(B L D)**

... Itinerary continued

Fri 16 Dec

Mandalay

Arrive Mandalay in the early morning. After breakfast, taking a tour by horse cart to visit the ancient city of Ava founded in 1364 by King Thadomin as his capital. Little remains of the old city. In its place stands the Maha Aungmye Bonzan Monastery and the Mae Nu Oak Kyaung, with their fine examples of Myanmar masonry, art and architecture.

Following lunch at a local restaurant visit the Sagaing Hills. Enjoy the spectacular panoramic views and stop by the convent, Soon U Ponya Shin Pagoda. Drive onto Amarapura and visit a textile workshop before enjoying sunset at the U Bein Bridge, the longest and oldest teakwood bridge in the world. **B L D**

Sat 17 Dec

Mandalay – Bagan

Late morning visit Yandabo, a remote village by the river bank. It is famous for the production of terracotta pottery made from river bank mud and view the pottery making process at various stages. Yandabo is also famous

in Burmese history as the place where the Treaty of Yandabo was signed in 1855 between the Burmese king and the British. **B L D**

Sun 18 Dec

Bagan

After a stunning sunrise and leisurely breakfast you reach magnificent Bagan, the capital city of Burma from 1044 to 1287, famed worldwide for two treasures: the endless plains studded with ancient Buddhist pagodas and its exquisite lacquer ware. This plain east of the curving Ayeyarwady is one of the most wondrous sights in Myanmar. Visit several of the 3,000 listed monuments, including Dhammayazika Paya, with its amazing view from the terrace, and the biggest temple, Dhammayangyi – both built in the 12th century – and one of the best preserved of all Bagan temples, the 11th-century Ananda.

(Optional Mt. Popa tour in the afternoon).

Tonight, celebrate the conclusion of the cruise with a traditional puppet show. **B L D**

Mon 19 Dec

Bagan – Yangon

Disembark the Anawrahta and transfer to Bagan Airport for a short flight to Yangon, for overnight.

Tonight, celebrate the conclusion of the tour with a special farewell dinner. **B D**

Tue 20 Dec

Depart Yangon

Tour arrangements conclude after breakfast.

There will be a transfer to Yangon Airport for suggested afternoon departure on Thai Airways to Bangkok, connecting with overnight flights to Australia. **B**

Wed 21 Dec

Arrive Australia

Morning (or afternoon) arrival in Australia.



Mingun Pahtodawgyi



Martaban jar © Ashley Van Haefen/Flickr

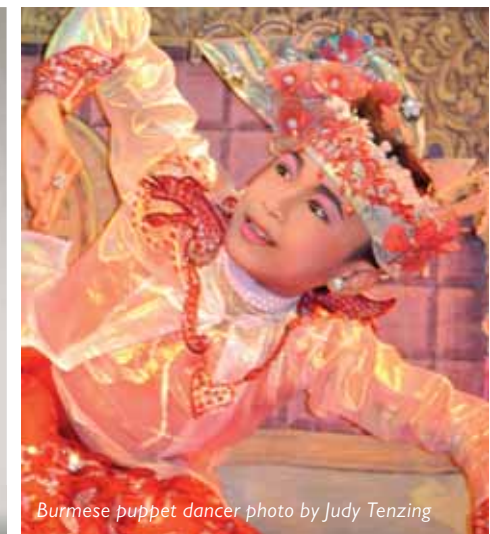

Burmese puppet dancer photo by Judy Tenzing

Anawrahta

Launched in 2015 the Anawrahta has a total of 16 deluxe cabins (32 sqm.) and 6 suites (50 - 58 - 84 sqm.). With the largest cabin space the Anawrahta is the perfect vessel on which to explore the mighty Ayeyarwady River. Built to resemble a British colonial paddle steamer the elegant 65 metre vessel features three spacious decks.

All cabins and suites have queen or king size beds and include safe, shower/WC, wardrobe, desk and chair and balcony. Executive and Royal Suites also feature a larger bathroom with bath/shower and armchairs in the sitting area as well as a larger balcony and panoramic window.

The Anawrahta features the Kipling bar, elegant Hinthia Hall Restaurant, the Mandalay Lounge and a full-length sun deck with deck-chairs, jacuzzi pool and navigation bridge. Other services include a gym and a spa.



Restaurant aboard the Anawrahta



Royal Suite



Executive Suite



Junior Suite



Deluxe Cabin

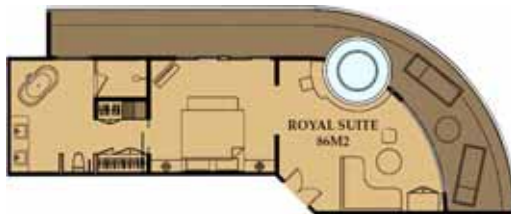

Royal Suite layout



Executive Suite layout



Junior Suite layout

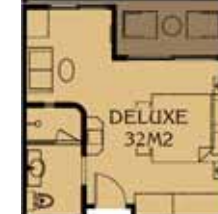

Deluxe Cabin layout

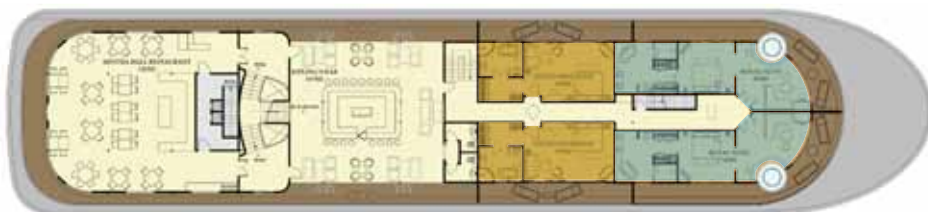

Terrace Deck



Upper Deck



Main Deck

Cabin Categories – Cruise / tour Yangon – Yangon 06–21 December 2016

■ Royal Suite	■ Junior Suite
■ Executive Suite	■ Deluxe Cabin

Tour prices

PP, twin share – Royal Suite	AUD 23,000
PP, twin share – Executive Suite	AUD 21,500
PP, twin share – Junior Suite	AUD 19,750
PP, twin share – Deluxe Cabin	AUD 17,500
PP, single – Deluxe Cabin	AUD 23,250
Deposit per person	AUD 1000
Final payment due	06 October 2016

*PP - all prices are per person.

*Single travellers may request to share.
Please advise at time of booking.

Early booking reduction - AUD 250
Per person, if booked and deposited
by 30 November 2015

Tour code AG1620

Fitness level Moderate

Please see booking conditions
for fitness level definitions.

Your hotels★★★★

Yangon – Shangri La Hotel
Mandalay – Sedona Hotel

*NB. Hotels of a similar standard
may be substituted*

Cruise and tour prices include

- International flights with Thai Airways Australia/Bangkok/Yangon/Bangkok/Australia (23 kg checked luggage allowance)
- Domestic flights Yangon/Mandalay and Bagan/Yangon (20 kg)
- 11 nights' cruise on Anawrahta in your choice of cabin or suite, including all meals
- Other meals in Yangon and Mandalay as per itinerary (**B**=Breakfast, **L**=Lunch, **D**=Dinner)
- Mineral water, coffee/tea, soft drinks and local beer with meals (where wines are available, at own expense)
- Transfers on arrival and departure if travelling on included flights
- Comprehensive sightseeing including entrance fees as per itinerary
- Visa for Myanmar
- Lectures and talks with your tour leader
- Gratuities for local guides and drivers
- Hotel and ship portorage

Cruise and tour prices do not include

- Transfer on arrival and departure if not travelling on suggested/included flights
- Airport portorage, Wi-fi, bar drinks on board
- Items of a personal nature, including telephone, laundry, mini-bar etc.
- Travel insurance

To book, call **1300 727 095** (AU) or 0800 403 621 (NZ),
visit **renaissancetours.com.au** or contact your travel agent.

Terms & Conditions

HOW TO BOOK

Complete, sign and return the Booking Form available from Renaissance Tours with your deposit and page one of your passport.

DEPOSIT / FINAL PAYMENTS

Your deposit is due at the time of booking and is used to pay hotel, airline, performance tickets and/or other deposits. It is non-refundable in the event of your cancellation.

Final payment is due 60 days before departure. Failure to make the final payment by the due date may result in cancellation of your booking and loss of deposit.

Payment by cash, cheque, direct deposit, American Express, MasterCard and Visa is accepted. 1.5% service charge applies to payment made by MasterCard and Visa. 3% service charge applies to payment made by American Express.

Payments for some international airfares can be made by credit card without a service fee. Please check for details.

CANCELLATION & REFUNDS

a) Cancellation by You – Cancellation charges will be applied as shown below, calculated from the day written notification is received by Renaissance Tours. In addition to cancellation fees for tours operated by Renaissance Tours as shown below, airlines, hotels and other third parties may impose up to 100% cancellation charges.

60 days or more	Forfeit of deposit
59 – 45 days	25% of tour cost
44 – 31 days	50% of tour cost
30 – 15 days	75% of tour cost
Less than 15 days	100% of tour cost

The above cancellation charges include applicable GST.

In addition to the above, cancellation charges may apply for additional arrangements booked by Renaissance Tours, such as air tickets, hotels and travel insurance premium. If the reason for cancellation is covered by the insurance policy, you may be able to reclaim these charges.

b) Cancellation by Us – We reserve the right to cancel a tour for any reason (such as failure to reach minimum tour participant numbers). Except for

force majeure, we will not cancel a tour less than 60 days before departure. No further compensation will be paid in the event of cancellation by Renaissance Tours. A full refund of monies paid for tour costs will be the full extent of our liability.

Cancellation and/or amendment fees may apply for additional travel arrangements booked by Renaissance Tours.

PASSPORTS, VISAS AND VACCINATIONS

All travellers must be in a possession of a valid passport – most countries require a 6-month validity from your date of entry or exit. For some countries (e.g. China, Vietnam, India, Russia), visas are included in the tour cost and will be arranged by Renaissance Tours prior to travel. For other countries, it is your responsibility to ensure you have the appropriate visa(s).

You are also responsible for obtaining all necessary inoculations and preventative medicines as may be required for the duration of the tour.

TOUR PRICES

Prices quoted in our tour information are based on exchange rates, cost of services and applicable taxes at the time of publication. Prices may be subject to change in the event of significant currency fluctuations or the introduction of new taxes, up until final payment is received.

In the event of a price increase, whether because of a currency fluctuation, increase in taxes or a correction in advertised prices, we will advise you and you have the option of accepting the amended prices, inclusions and booking conditions or withdrawing from the tour and receiving a full refund of all monies paid.

Once final payment is received, all prices will be guaranteed and no surcharges will apply.

TRAVEL INSURANCE

It is a condition of travel that you are covered by comprehensive travel insurance for international tours. Your travel insurance can be arranged by Renaissance Tours.

FITNESS AND PARTICIPATION

Most of our tours require a MODERATE level of fitness.

However, in certain destinations (e.g. Silk Road, Central Asia, Outback Australia, tropical destinations) or in certain seasons (e.g. mid-winter, mid-summer) or because of the nature of travel (e.g. remote rail), certain tours will require an ABOVE AVERAGE or CHALLENGING level of fitness.

If you (or we) have any doubts about your level of fitness, you may be required to have a doctor's appraisal. This would require your doctor to read the itinerary of your chosen tour, including the fitness level, and provide you (and us) with a written confirmation of your ability to participate.

MODERATE

For the overall benefit of the group, all tour members must possess a moderate level of mobility, including the ability to:

- negotiate airports and railway stations without wheelchair assistance
- use combined shower/bath facilities (it is impossible to guarantee walk-in shower facilities)
- undertake walking tour of 1–2 hours duration, including using stairs, walking over cobblestones and other uneven surfaces
- stand for long periods in museums and other sites
- embark / disembark coaches, trains and other methods of transportation without assistance
- handle your own luggage

ABOVE AVERAGE

In addition to the above, tour members must also be able to:

- undertake walking tours of 2–3 hours
- climb staircases of 100 or more steps

CHALLENGING

In addition to the above, tour members must also be able to:

- handle extremes of temperature (e.g. below 0 or above 35 degrees)
- handle extremes of altitudes (e.g. 4000 metres and above).

You can find the full terms & conditions at www.renaissancecettours.com.au/booking-conditions or we would be happy to post you a copy on request.



1300 727 095 (AU)
0800 403 621 (NZ)

t (02) 9299 5801
f (02) 9299 5805
e info@renaissancettours.com.au
w www.renaissancettours.com.au

Level 4, 47 York Street, Sydney NSW 2000
GPO Box 5068, Sydney NSW 2001
ABN 14 069 591 448

Travel agent